

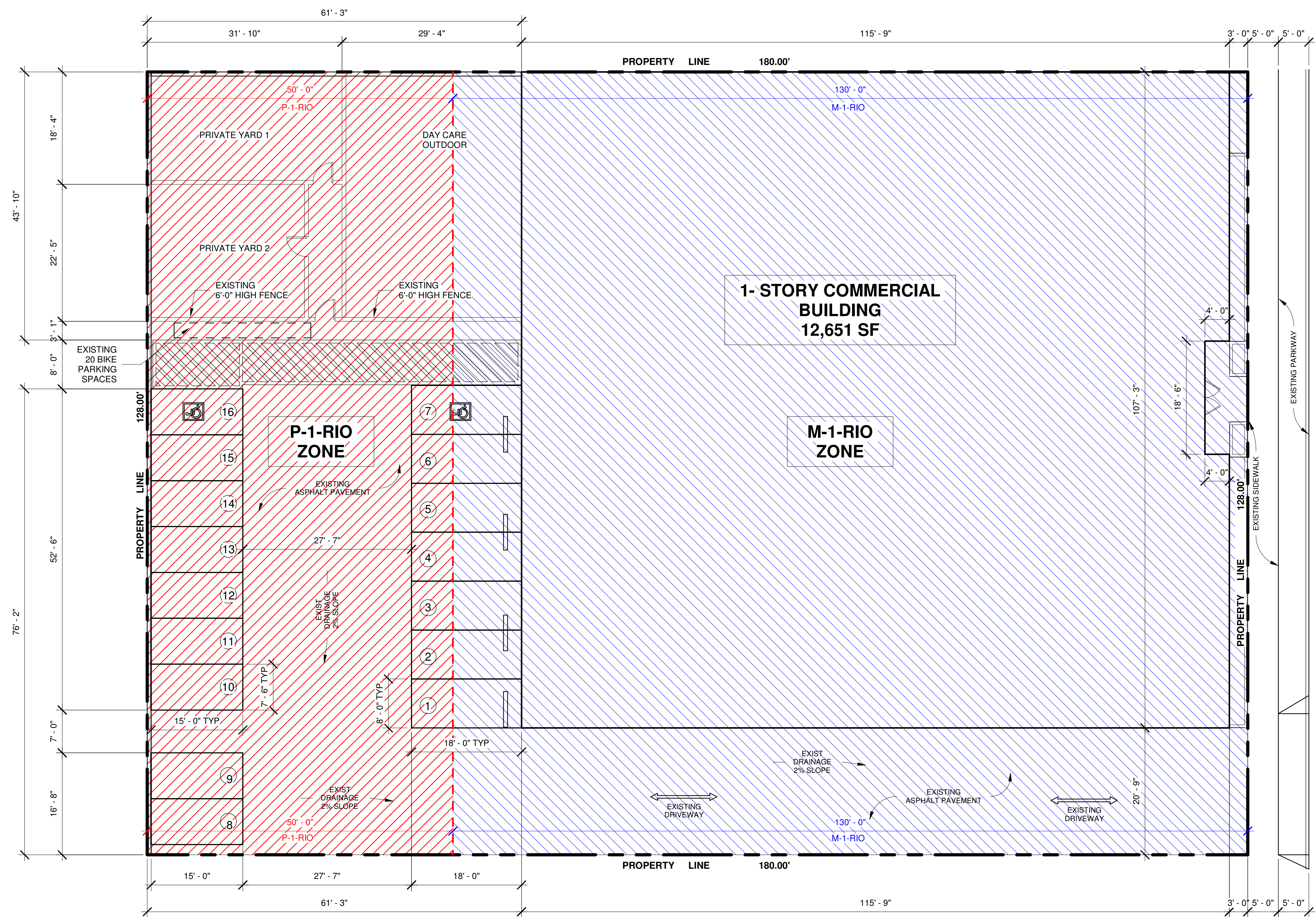

SUSAN SOLIZ
CONSTRUCTION PLANS & PERMITS LLC
cell (805) 298-2058
susansoliz@hotmail.com

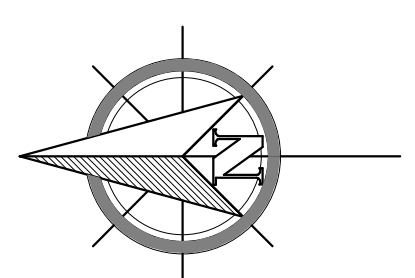

↑ 18603 W TOPHAM ST. ↓

SITE PLAN

Scale : 3/32" = 1'-0"

SCOPE OF WORK

1 - EXISTING 1-STORY COMMERCIAL BUILDING 12,651 SF
--

SITE PLAN LEGEND

TYPE OF BUILDING	DESCRIPTION
	EXISTING BUILDING
	PROPERTY LINE

CODE INFORMATION

PROJECT TO COMPLY WITH :

APPLICABLE CODE	YEAR
CBC CALIFORNIA BUILDING CODE	2019
CPC CALIFORNIA PLUMBING CODE	2019
CMC CALIFORNIA MECHANICAL CODE	2019
CEC CALIFORNIA ELECTRICAL CODE	2019
CFC CALIFORNIA FIRE CODE	2019
LABC LOS ANGELES BUILDING CODE	2020

ALONG W/ THE 2019 T-24 ENERGY STANDARDS

PROJECT SUMMARY

ADDRESS / LEGAL INFORMATION

PROJECT ADDRESS :	18603 W TOPHAM ST, TARZANA, CA 91335
ASSESSOR PARCEL No. (APN) :	2127-016-033
LOT AREA :	23106.40 SF
ZONING :	M1-1-RIO / P-1-RIO
TRACT :	P M 2620
LOT :	B
OCCUPANCY GROUP :	B
TYPE OF CONSTRUCTION :	V-B
STORIES :	1
HEIGHT OF BUILDING :	12' - 0"

FLOOR AREAS

EXISTING 1-STORY HOUSE :	12651 SF
--------------------------	----------

REVISION SCHEDULE

No.	DATE	DESCRIPTION

PROJECT ISSUED FOR: _____ DATE: _____

PROJECT NAME :
EXIST. 1-STORY COMMERCIAL BUILDING NVA-K9s ONLY
ADDRESS :
18603 W TOPHAM ST. TARZANA, CA 91335
OWNER :
CHRIS RICCIO
CONTACT PHONE :
818.518.5979

PROJECT No :
R005-2021
DRAWN BY :
Author
CHECKED BY :
Checker
SCALE :
As Indicated
SHEET ISSUE DATE :
10/29/22

SITE PLAN

SHEET NUMBER :
A1

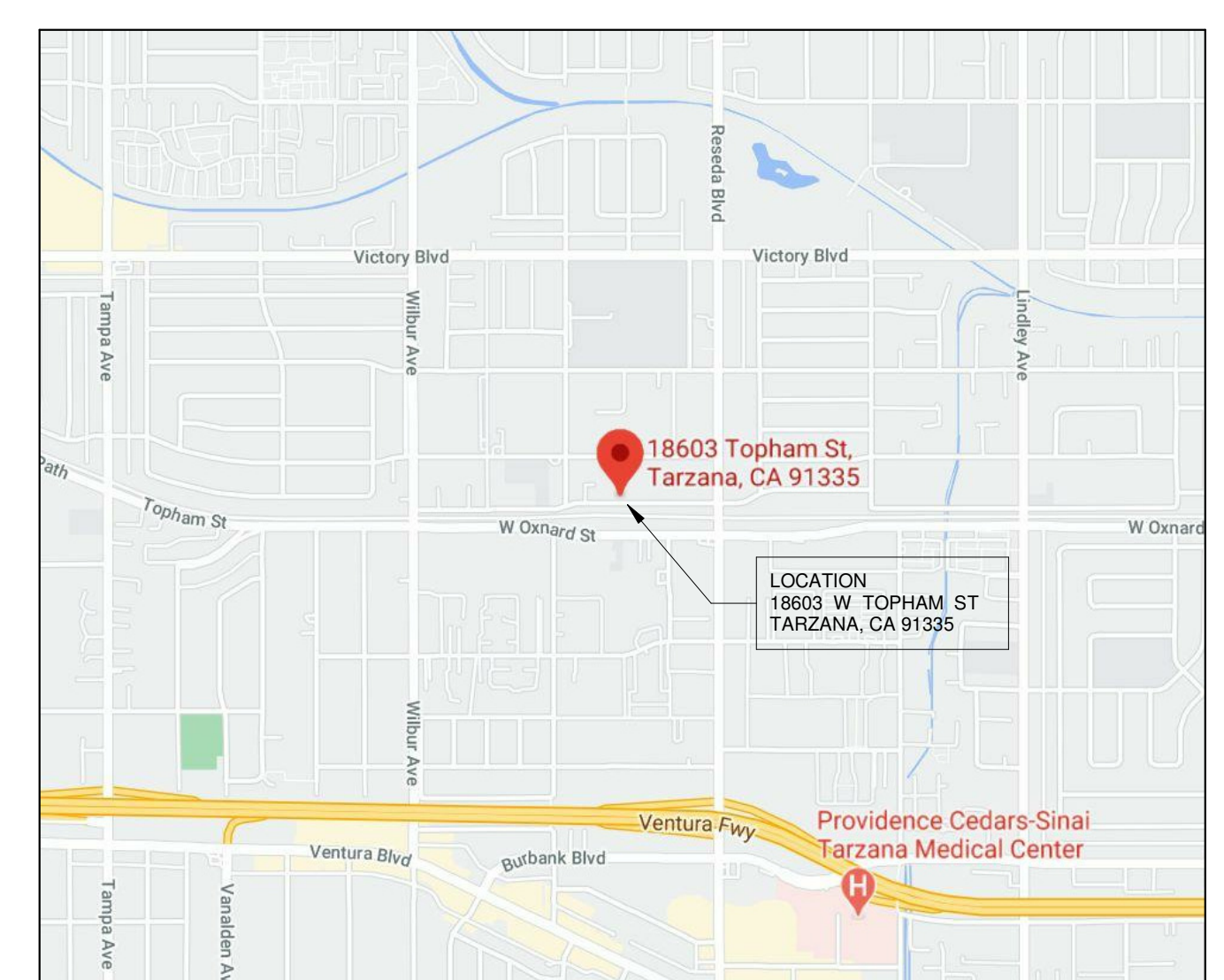

PROJECT LOCATION MAP