

EXISTING LAND USES



5521, 5531 & 5545 N. RESEDA BLVD. & 18525, 18531 W. CLARK STREET

CASE NO.

DATE: 06 - 06 - 2016

SCALE:

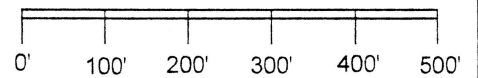

GC MAPPING SERVICE

3055 WEST VALLEY BOULEVARD

ALHAMBRA CA 91803

(626) 441-1080, (626) 441-8850

gcmapping@radiusmaps.com

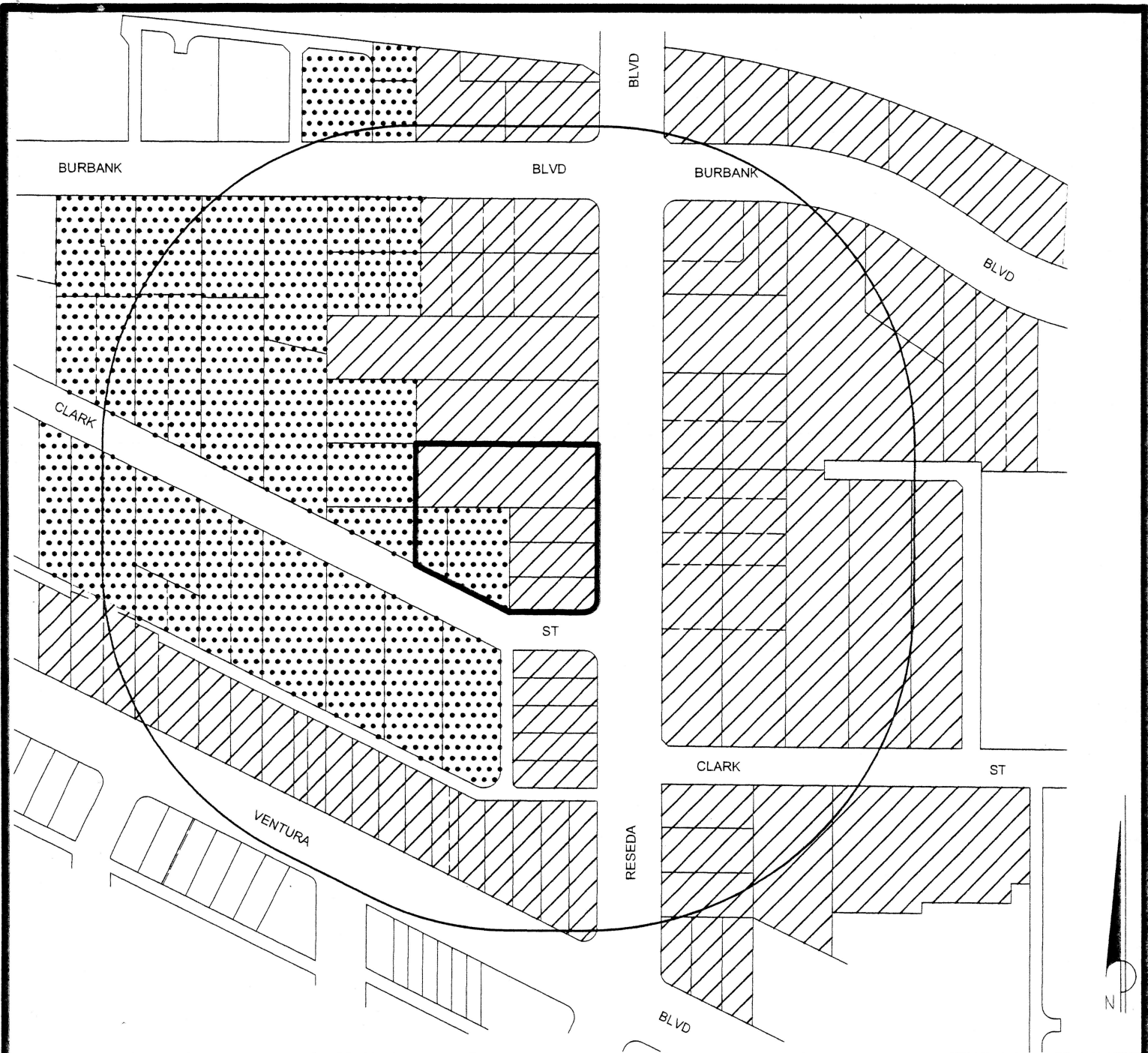

EXISTING - ENCINO - TARZANA COMMUNITY PLAN



MEDIUM RESIDENTIAL - R3



COMMUNITY COMMERCIAL - CR, C2, C4, RAS3

CASE NO.

DATE: 06 - 06 - 2016

SCALE:

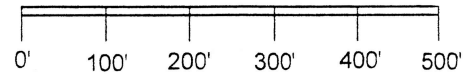

GC MAPPING SERVICE

3055 WEST VALLEY BOULEVARD

ALHAMBRA CA 91803

(626) 441-1080, (626) 441-8850

gcmapping@radiusmaps.com

CPC 2016 288 1

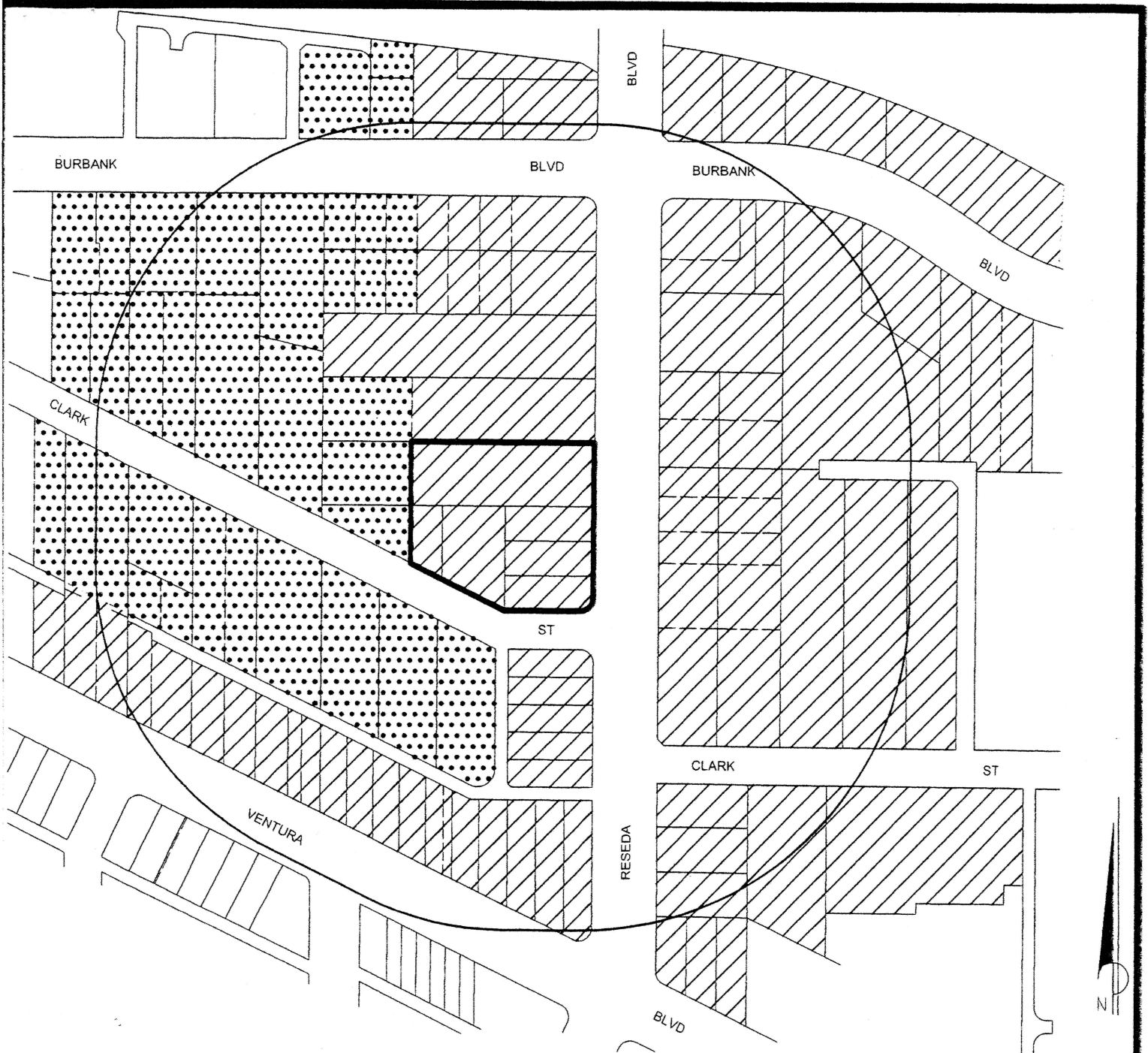

REQUESTED - ENCINO - TARZANA COMMUNITY PLAN



MEDIUM RESIDENTIAL - R3



COMMUNITY COMMERCIAL - CR, C2, C4, RAS3

CASE NO.

DATE: 06 - 06 - 2016

SCALE:

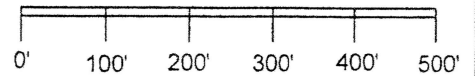

GC MAPPING SERVICE

3055 WEST VALLEY BOULEVARD

ALHAMBRA CA 91803

(626) 441-1080, (626) 441-8850

gcmapping@radiusmaps.com

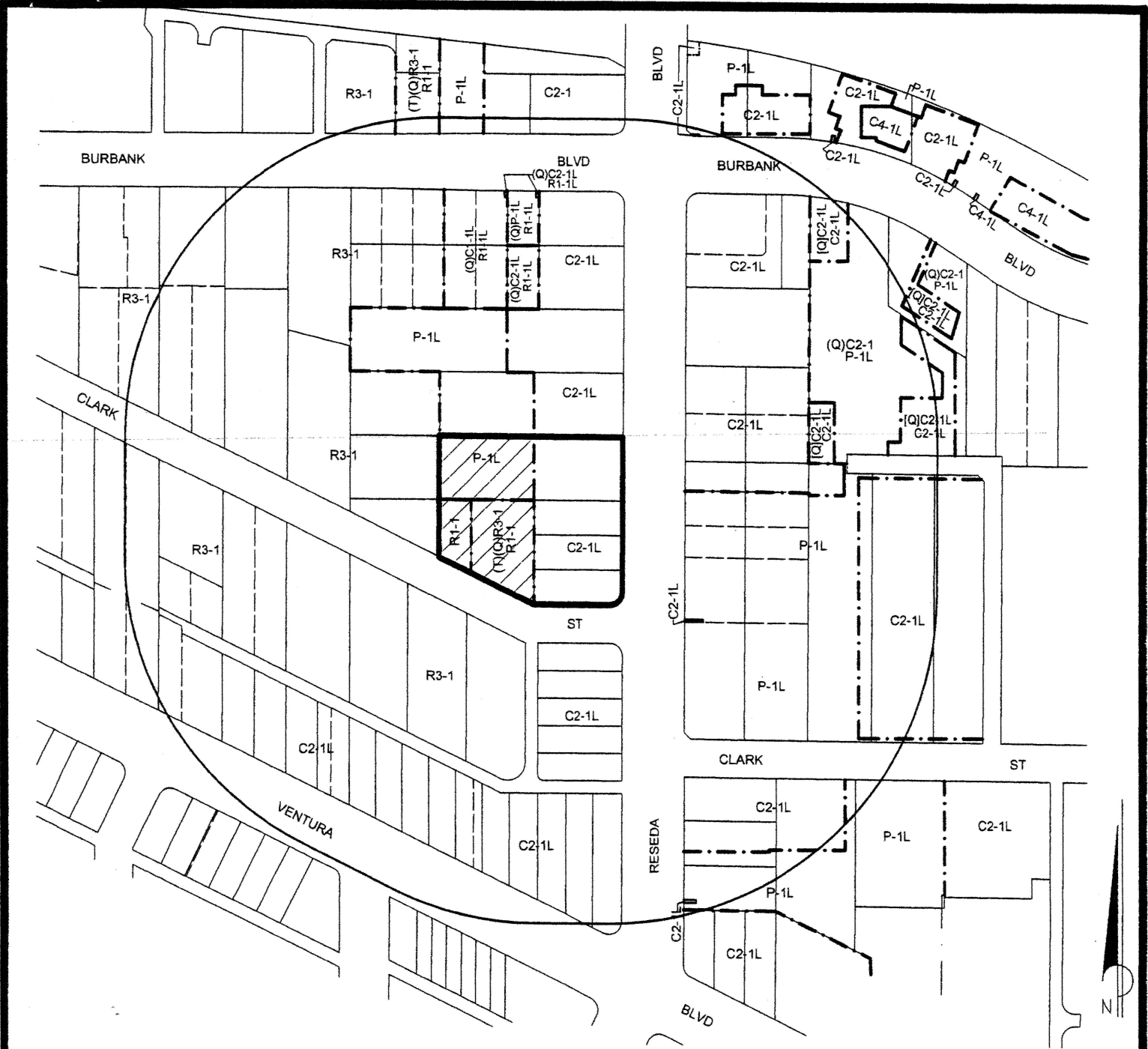

EXISTING ZONING



(T)(Q)R3-1, R1-1 & P-1L TO C2-1L



ZONE BOUNDARY LINE

CASE NO.

DATE: 06 - 06 - 2016

SCALE:

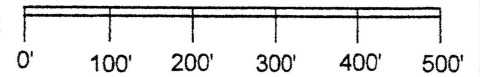

GC. MAPPING SERVICE

3055 WEST VALLEY BOULEVARD
ALHAMBRA CA 91803

(626) 441-1080, (626) 441-8850

gcmapping@radiusmaps.com